

52A INTERIOR

GENERAL

OUTLINE OF CHANGES

- The following maintenance service points have been changed to correspond to the adoption of center floor box.

CENTER FLOOR BOX

REMOVAL AND INSTALLATION

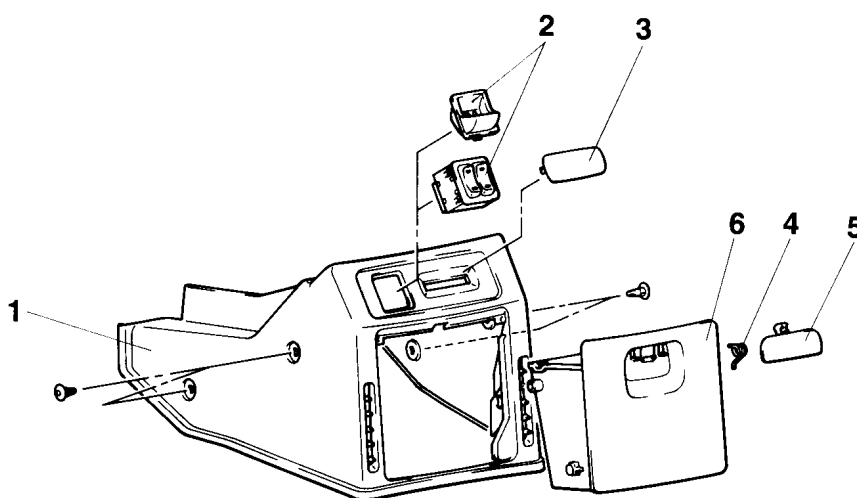

19W0306

Removal steps

1. Center floor box cover
2. Coin plug or heated seat switch
3. Plug
4. Spring
5. Lock knob
6. Center floor box